



Installation manual

Model: LAND ROVER Discovery III/
LAND ROVER Diskovery IV

Skid plate for: transmission case and transfer box
SAMPLE

Article: 04.1930/ 04.1320

Body type: TAA

Years: 2004-/ 2009-

Engine type: 4,4; 2,7TD/ 4,4; 2,7TD

APPLICATION:

Protection of engine bay and transmission elements from damage.
Protection of engine bay and transmission elements from dust and water.

INSTALLATION:

This protection plate has been designed for installation to the intended application only. It should be mounted according to these installation instructions by an experienced Ironman 4x4 dealer or certified fitter. The plate is fixed to original vehicle mountings located on the vehicle's body load-bearing elements. Upon successful installation the plate should not interfere with any other parts or components.

INSTALLATION MANUAL:

1. Skid plate can be installed without engine bay skid plate.
2. Mount threaded into apertures of the transmission bar.
3. Fix the skid plate's front part to the subframe's OE points.
4. Fix the skid plate's rear part to the mounted inserts.
5. Tighten all screw joints.

WARRANTY:

Warranty period - 12 Months

WARRANTY TERMS:

The plate should only be installed on a vehicle with undamaged body and load-bearing elements, vehicles which have been involved in a significant collision may prevent successful installation.

Ironman 4x4 does not bear liability for any damages caused to the vehicle, or injury to persons in case of installation or product failure. Ironman 4x4 has a right to introduce changes into the skid plate construction.

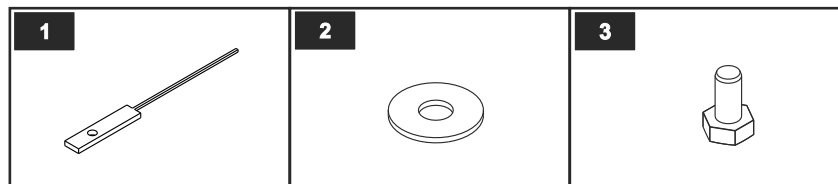
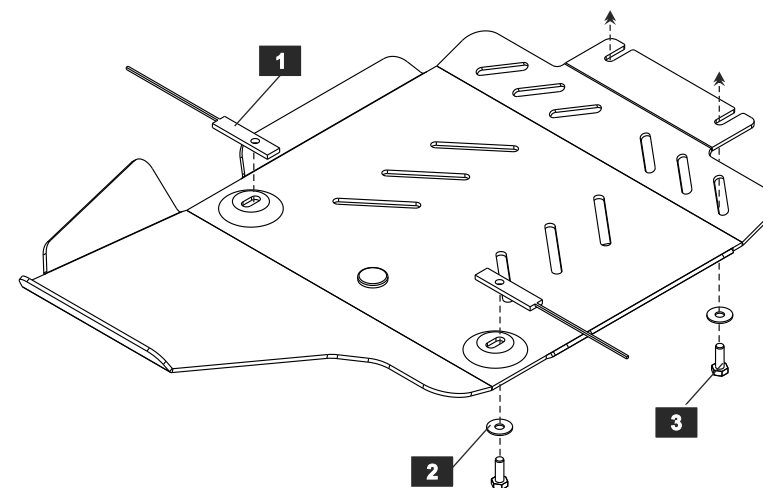

LIST OF PARTS

NO.	NAME	QTY.
1	Threaded insert	2
2	Washer 10	4
3	Bolt M 10x30	4
4		

Thread	M6x1.0	M8x1.25	M10x1.5	M12x1.75
Tightening torque	9.8 Nm	24.0 Nm	47.0 Nm	81.0 Nm